

École Warman Elementary School – 2024-2025

Stop #	Bus Color	Route #	Departure	Drop Off	Stop location
1	Gold	WR-11	8:09 am	2:55 pm	<ul style="list-style-type: none"> Rigmor Street (across from 120)
2	Gold	WR-11	8:12 am	2:57 pm	<ul style="list-style-type: none"> 5th Avenue South (eastside – btw Canora St & South Railway St. W)
3	Gold	WR-11	8:10 am	2:56 pm	<ul style="list-style-type: none"> 6th Avenue South & Elizabeth Street East (across from 102)
4	Orange	WR-05	8:11 am	3:00 pm	<ul style="list-style-type: none"> Crystal Springs Drive (East alley between Brooklyn Lane & Crescent)
5	Brown	WR-15	8:05 am	3:07 pm	<ul style="list-style-type: none"> Ballesteros Crescent & Casper Crescent intersection (mailboxes)
6	Grey	WR-10	8:10 am	2:55 pm	<ul style="list-style-type: none"> Brookside Drive (across 206)
7	Grey	WR-10	8:17 am	3:01 pm	<ul style="list-style-type: none"> Crystal Springs Lake greenspace
8	Lime	WR-13	8:13 am	2:56 pm	<ul style="list-style-type: none"> 4th Street East (across from 433) between Antler Cres & Deer Court
9	Brown	WR-15	8:02 am	3:03 pm	<ul style="list-style-type: none"> Mickelson Lane (across from 505)
10	Grey	WR-10	8:16 am	3:00 pm	<ul style="list-style-type: none"> Braun Lane (alley between White Oak & Redwood Crescent)
11	Brown	WR-15	8:12 am	2:53 pm	<ul style="list-style-type: none"> 8th Avenue & 1st Street intersection (across from 4-plexes)
12	Brown	WR-15	8:15 am	2:55 pm	<ul style="list-style-type: none"> 5th Avenue & Main Street Intersection (across from Awakening Church)
13	Orange	WR-05	8:05 am	2:54 pm	<ul style="list-style-type: none"> Warwick Crescent (across from 117)
14	Light Purple	WR-16	8:10 am	3:11 pm	<ul style="list-style-type: none"> Player Crescent & Mize Gate (Rick Unger Park)
15	Lime	WR-13	8:11 am	2:55 pm	<ul style="list-style-type: none"> 8th Avenue North & Watson Way (Linda Schaefer Park)
16	Brown	WR-15	7:57 am	3:12 pm	<ul style="list-style-type: none"> 1st Avenue & Diamond Street (greenspace)
17	Grey	WR-10	8:14 pm	2:58 pm	<ul style="list-style-type: none"> Silver Birch Lane greenspace (across from 503)
18	Light Purple	WR-16	8:07 am	3:08 pm	<ul style="list-style-type: none"> Snead Crescent walking path (between 428 & 430)
19	Gold	WR-11	8:16 am	3:09 pm	<ul style="list-style-type: none"> Brooklyn Crescent greenspace between 334 & 332
23	Orange	WR-05	8:07 am	2:56 pm	<ul style="list-style-type: none"> Martens Street (across 423) between Martens Cres & Martens Lane
40	Brown	WR-15	8:04 am	3:05 pm	<ul style="list-style-type: none"> Glen Abby Boulevard (mailboxes btw Scott & Wier Crescent)

Students are to be at the stop 5 minutes before departure time.

Things to know:

- Times fluctuate for various reasons; therefore, please revisit the website periodically for updates.
- Visit our website, www.spiritsd.ca/buses/ to see daily alerts for each bus route.
- Bus passes will be distributed to the students by the schools, 24 hours after the request has been approved.
- Bus requests are to be submitted directly online at <https://pspt.mybusplanner.ca/default> and have a 7-business day processing time throughout the year; however, requests submitted in August and September may be longer.

Updated January 23, 2025

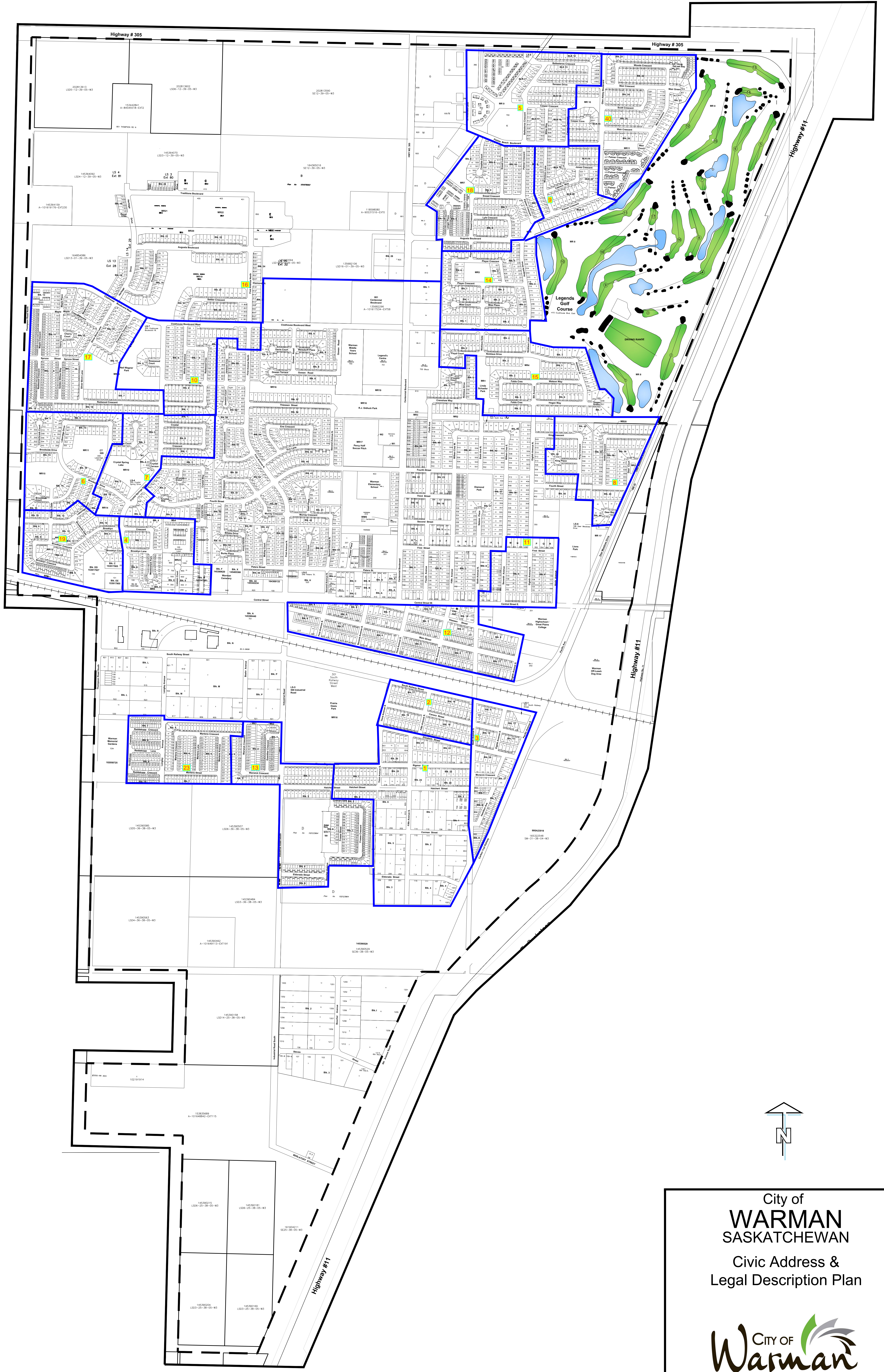

City of
WARMAN
 SASKATCHEWAN
 Civic Address &
 Legal Description Plan

